

X63N

410Nm

BVN Series

Full stainless steel helical gearboxes

The dynamic efficiency is 0.94 for all ratios

Input speed (n₁) = 1400 min⁻¹

Output speed n ₂ [min ⁻¹]	Ratio i	Motor power P _{1M} [kW]	Output torque M _{2M} [Nm]	Service factor f.s	Nominal power P _{1R} [kW]	Nominal torque M _{2R} [Nm]	B5 motor flanges			B14 motor flanges			Output shaft	Ratio code
							-	-	-Q	-R	-T	71		
24.7	56.76	1.1	398	1.0	1.1	410			C	C		191311	standard ø35	01
21.3	65.79	0.75	316	1.3	0.97	410			C	C		171311		02
18.1	77.23	0.75	371	1.1	0.83	410			C	C		151311		03
16.0	87.23	0.75	420	1.0	0.73	410			C	C		19138		04
15.2	92.18	0.75	443	0.9	0.69	410			C	C		131311		05
13.9	100.47	0.55	357	1.2	0.64	410			C	C		19811		06
12.0	116.45	0.55	413	1.0	0.55	410			C	C		17811		07
11.1	125.82	0.55	446	0.9	0.51	410			C	C		101311		08
9.9	141.66	0.37	336	1.2	0.45	410			C	C		13138		09
8.6	163.16	0.37	387	1.1	0.39	410			C	C		13811		10
7.8	178.96	0.37	424	1.0	0.36	410			C	C		1788		11
7.2	193.36	0.37	459	0.9	0.33	410			C	C		10138		12
6.5	216.84	0.25	347	1.2	0.29	410			C	C		71311		13
5.5	252.36	0.25	404	1.0	0.25	410			C	C		9138		14
4.8	290.67	0.25	465	0.9	0.22	410			C	C		9811		15
4.2	333.23	0.25	533	0.8	0.19	410			C	C		7138		16
3.6	383.82	0.25*	614	0.7	0.17	410			C	C		7811		17
3.1	446.70	0.25*	715	0.6	0.14	410			C	C		988		18
2.4	589.85	0.25*	944	0.4	0.11	410			C	C		788		19

* Power higher than the maximum one which can be supported by the gearbox. Select according to the torque M_{2R}

Motor flanges available



B) Supplied with reduction bushing

B) Available on request without reduction bushing



C) Motor flange holes position

Lubrication

Unit X63N is supplied with synthetic oil to assure long life lubrication.

Food grade oil is available on request.

See Table 1 for lubrication and recommended quantity.

See Table 2 for possible radial and axial loads on the gearbox.

Shell	Eni	V8	
Omala S4 WE 320	Telium VSF 320	On request ASK	
B3 Standard 2.05 L		B8 On request 1.90 L	
B6 On request 1.85 L		V5 On request 3.40 L	
B7 On request 1.70 L		V6 On request 2.25 L	

Radial and axial loads

Output shaft

n ₂ [min ⁻¹]	F _a [N]	F _r [N]
250	600	3000
150	700	3500
100	780	3900
75	890	4450
50	1140	5700
25	1330	6650
15	1660	8300

$$F_{eq} = F_R \cdot \frac{168}{X + 138}$$

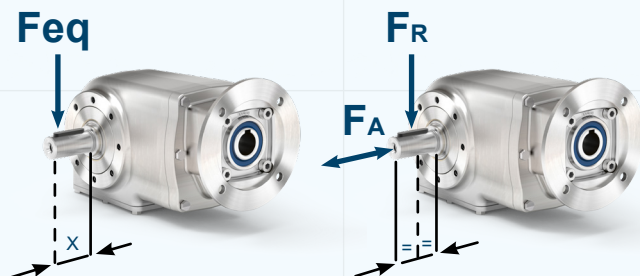

X63N

410Nm

PX63NI FB

Basic gearbox

M. flanges	Kit code	øF	A
71B14	KI634047	105	263
80B14	KI634046	120	265
90B14	KI634041	140	265

Gearbox weight	23.2 kg
----------------	---------

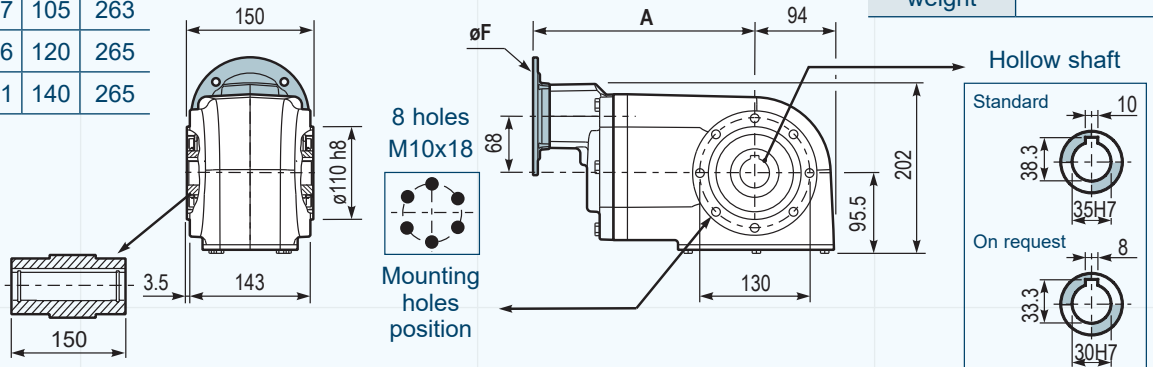

PX63N PA

Feet

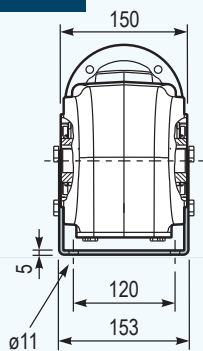

PX63N PV

Feet

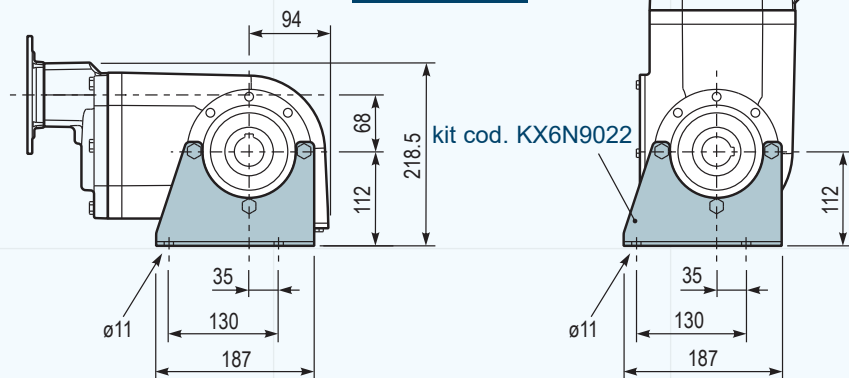

PX63N-FL

Output flange

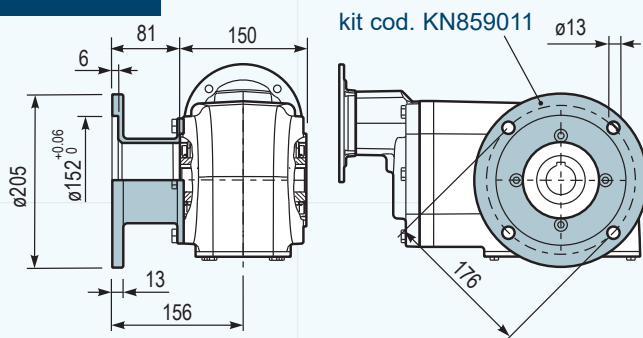

PX63N BR

Reaction arm

kit cod. KN859027

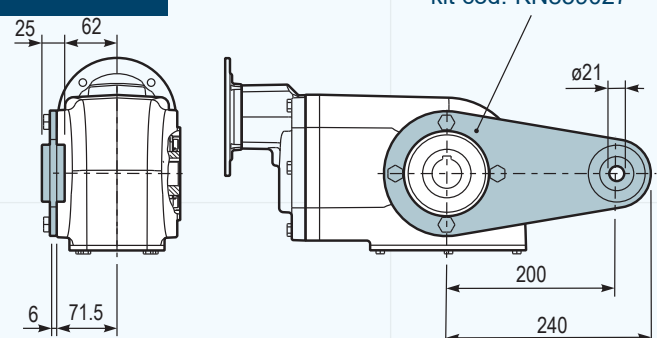

PX63N A

Single output shaft

kit cod. KIX6A5028

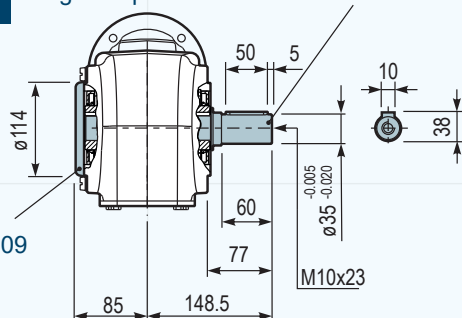

kit cod. KN850209
Protection cap
(on request)

Suggested

Stainless steel protection cap
(on request).

kit cod. KN850209

